



Thank you for purchasing this Elite product. You will need the following tools:
Phillips Head Screw Driver • Straight Blade Screw Driver • Rubber Padded Hammer or Mallet

Assembly Instructions

Audio Rack on Casters EL-141 and EL-141S

PLEASE NOTE:

The following numbers and letters correspond to the sketches in this instruction booklet.

CABINET PARTS:

1. Top Panel
2. Bottom Panel
3. Left and Right Side Panels (identical)
4. Two Vertical Mouldings (identical)
5. Three Adjustable Shelves (identical)
6. Back Panel (2 identical)
7. Glass Door

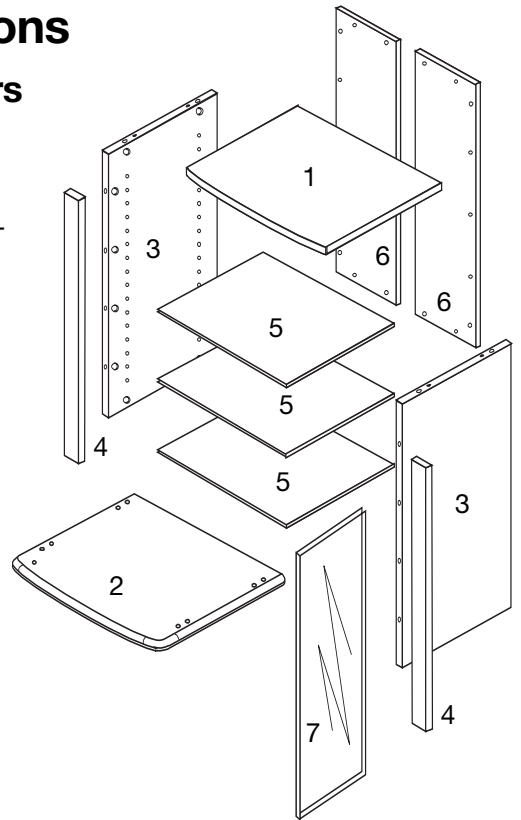
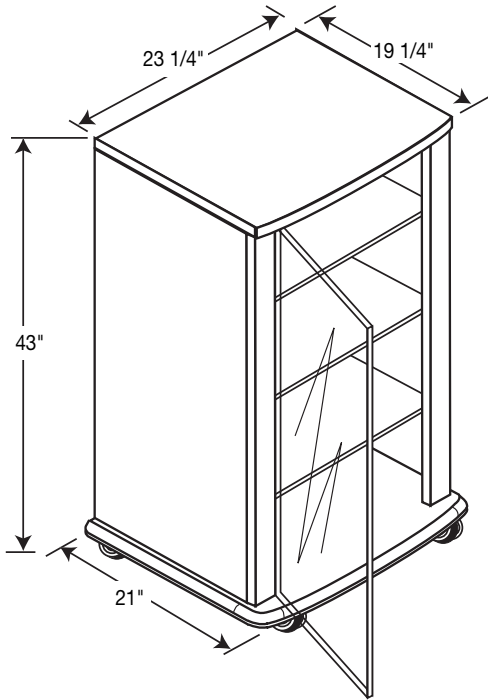

Hardware for cabinet assembly

A 16 Connecting Bolts	B 4 Casters	C 16 5/8" Wood Screws for Casters	D 1 Magnetic Touch Latch	E 2 1/2" Wood Screws for Magnet	F 16 Camlocks	G 18 5/8" Wood Screws for Back Panel	H 12 1" Long Shelf Pins
J 16 Plastic Camlock Covers	K 8 Wooden Dowels	S 4 Glass Door Hinges		T 2 Protective Plates	U 1 Metal Strike Plate	V 1 Foam Protective Pad	W 2 Plastic Bushings

Hardware for door assembly

IMPORTANT NOTES & CAUTIONS/WARNINGS

- Carefully read and follow these instructions for assembly.
- Please handle parts carefully, some parts may be heavy.
- To protect the unit and your flooring surface we recommend working on a padded or carpeted area, you may also use the open box the unit came in for this purpose.
- For proper construction & integrity/assembly and for TV weight support and safety, all con-

nections need to be sufficiently tight. However, do not over-tighten connections to the point of stripping screw threadings. Parts are designed to fit together tightly, however, avoid excessive force but rather align & fit panels together methodically and with patience.

- For some heavy or large units, it may be recommended for 2 people to work together on this assembly.

- It is extremely important to attach the **BACK PANEL** as instructed within this manual. Such panels are crucial for the stability and structural support of the unit.
- Please read additional **important safety information** at the end of this instruction manual.
- We urge you to keep this manual with your unit for future reference.

SPECIAL NOTE

In all steps involving camlocks, please note the correct position of the camlock in the illustration at the left. Check all camlocks before aligning and joining pieces together.

IMPORTANT: Throughout assembly of the unit, camlocks must be inserted with the openings facing the nearest unfinished edge and screwdriver slot parallel to unfinished edge.

CAMLOCK/CONNECTING BOLT PROCEDURE

1 ALIGN CAMLOCK & CONNECTING BOLT

2 JOIN PIECES TOGETHER

3 TURN CAMLOCKS 180° CLOCKWISE USING A FLATHEAD SCREWDRIVER

1 PREPARE BOTTOM PANEL

On a padded surface, place Bottom Panel (2) with the bottom surface up. Attach 4 Casters (B) with Chrome Screws (C).

Turn Bottom Panel (2) over and insert 4 Connecting Bolts (A) as indicated into the small plastic threaded holes near the corners.

IMPORTANT: Throughout assembly of the unit, connecting bolts must be screwed in completely, however **do not overtighten**.

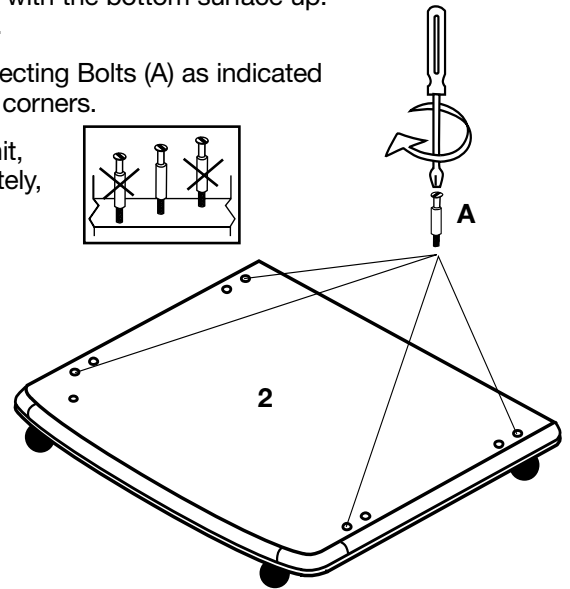
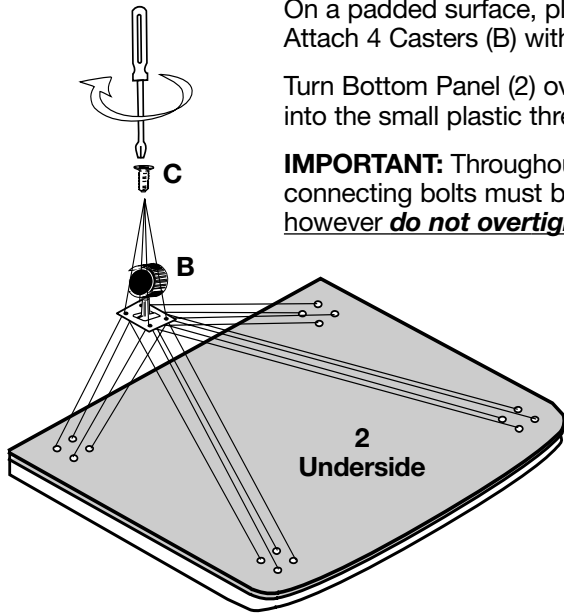

2 PREPARE TOP PANEL

With Top Panel (1) upside down, screw four Connecting Bolts (A) into the small plastic threaded holes near the corners.

Attach the Magnetic Door Latch (D) to the Top with 2 Wood Screws (E) into predrilled holes in the Top Panel so that the **magnet faces the front edge**.

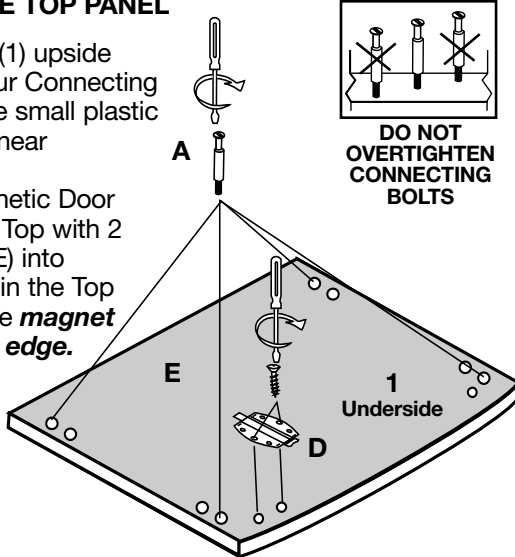

3 PREPARE MOULDINGS

Screw four Connecting Bolts (A) into the small holes for each Moulding (4).

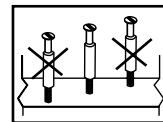
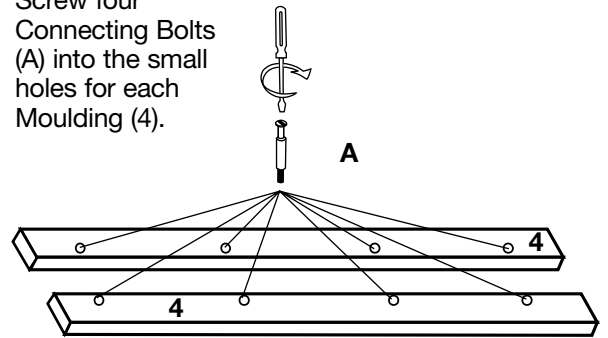

IMPORTANT: Throughout assembly of the unit, connecting bolts must be screwed in completely, however **do not overtighten**.

4 PREPARE SIDE PANELS

Place the Right and Left Side Panels (3) with the holes facing up.

Insert 4 Camlocks (F) into the 4 side holes and 2 Camlocks (F) into the top holes and 2 Camlocks (F) into the bottom holes. This is a total of 8 Camlocks for each Side Panel (3). **Make sure that the opening of each camlock is facing towards the edge nearest it.** To make sure that the camlocks are completely inserted, tap them lightly with the hammer.

Insert 2 Wooden Dowels (K) into the inner holes of both the top and bottom edges of each Side Panel (3).

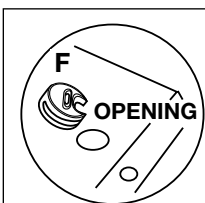

IMPORTANT: Throughout assembly of the unit, camlocks must be inserted with the openings facing to nearest unfinished edge and screwdriver slot facing up.

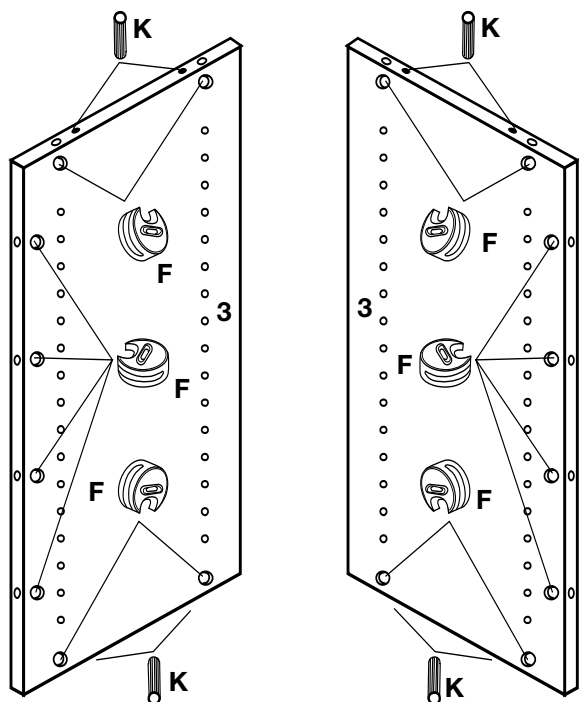

5 ATTACH MOULDINGS (4) TO SIDE PANELS (3)

Align the Connecting Bolts (A) of Moulding (4) with appropriate holes of the Camlocks (F) of Side Panel (3). Butt two pieces together. Turn Camlocks to locked position. (See diagram below.) Repeat procedure for remaining Moulding (4) and Side Panel (3).

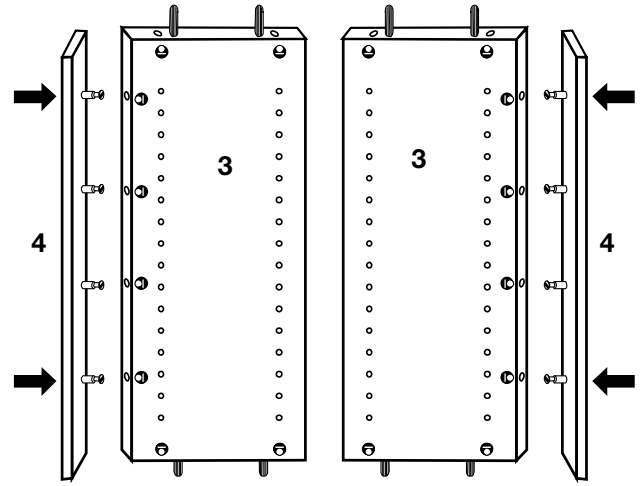
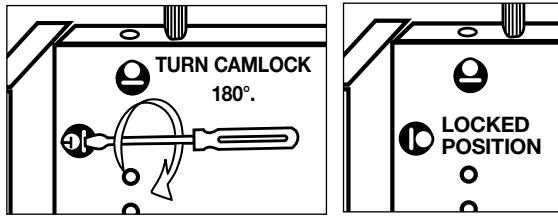

6 ATTACH TOP AND BOTTOM PANELS

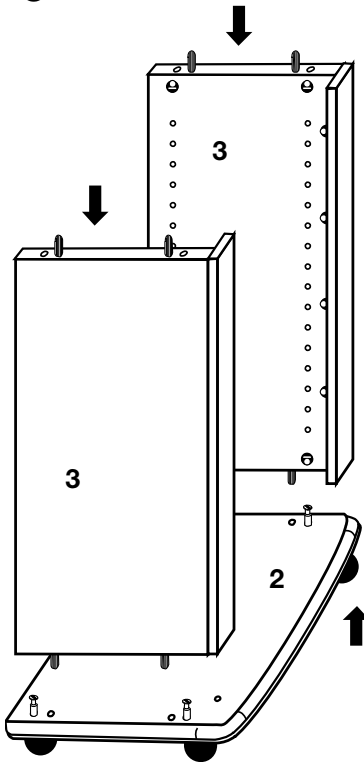

Place Bottom Panel (2) with Casters (B) down. Align Wooden Dowels (K) and holes of Side Panel (3) with appropriate holes and Connecting Bolts (A) of Bottom Panel (2).

Butt two pieces together. Turn Camlocks of bottom edge of Side Panel (3) to locked position.

(See diagram below.)

Repeat above procedure for remaining Side Panel (3).

When Attaching Top Panel, Be Sure to KEEP MAGNETIC LATCH TOWARD THE FRONT.

Align Wooden Dowels (K) and holes of Side Panel (3) with appropriate holes and Connecting Bolts (A) of Top Panel (1).

Butt two pieces together. Turn Camlocks of top edge of Side Panel (3) to locked position.

(See diagram below.)

Repeat above procedure for remaining Side Panel (3).

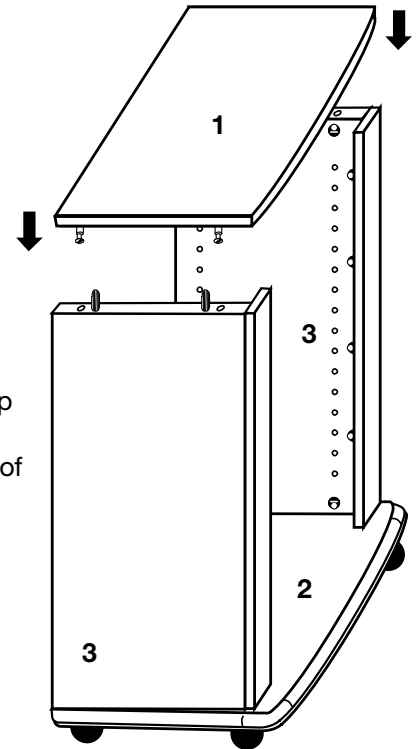
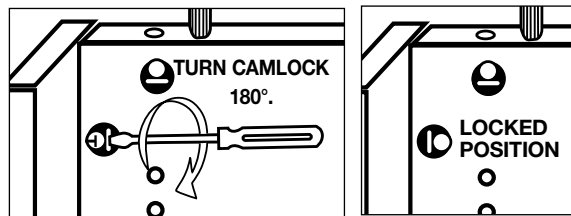

7 ADD ADJUSTABLE SHELVES FROM REAR OF UNIT

Insert shelf pins (H) into predrilled holes on insides of Left and Right Sides at desired heights and tap lightly into place.

Hold Adjustable Shelf (5) directly over shelf pins and lower into place. Repeat for remaining Adjustable Shelves (5).

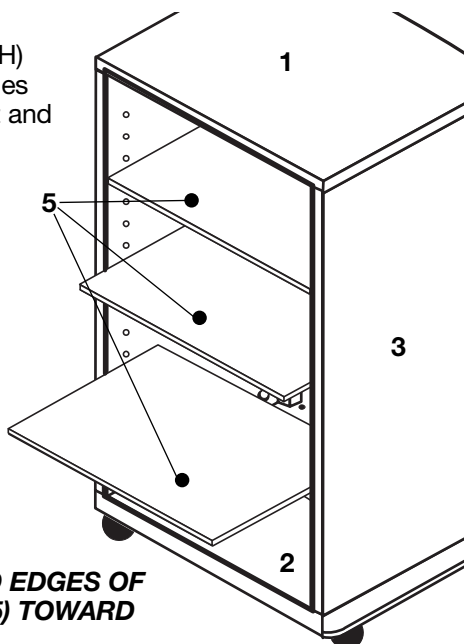

KEEP FINISHED EDGES OF ALL SHELVES (5) TOWARD THE FRONT

8 ATTACH BACK PANEL AND CAMLOCK COVERS

Take Back Panels (6) and insert it into the groove on the edges on the rear of the assembly so that it sits evenly and flush with the other edges. Screw the Back Panels into place using the 5/8" Black Wood Screws (G) provided.

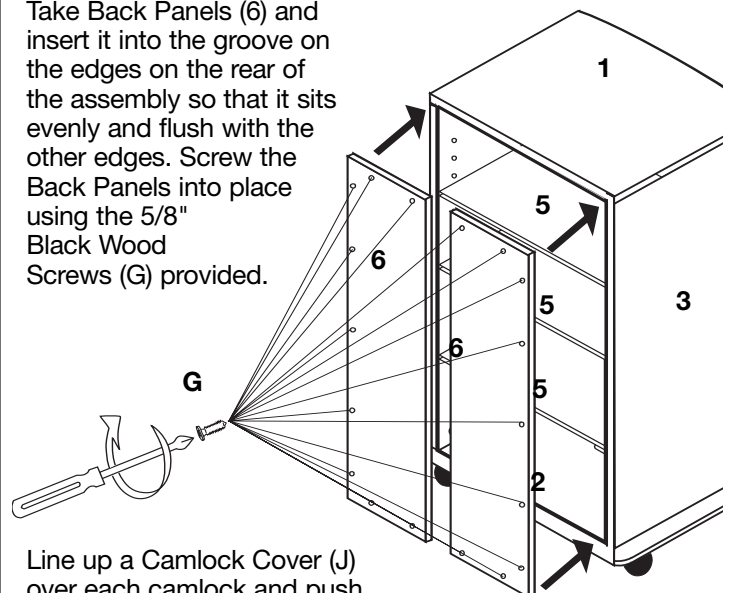

Line up a Camlock Cover (J) over each camlock and push the camlock cover into place.

9

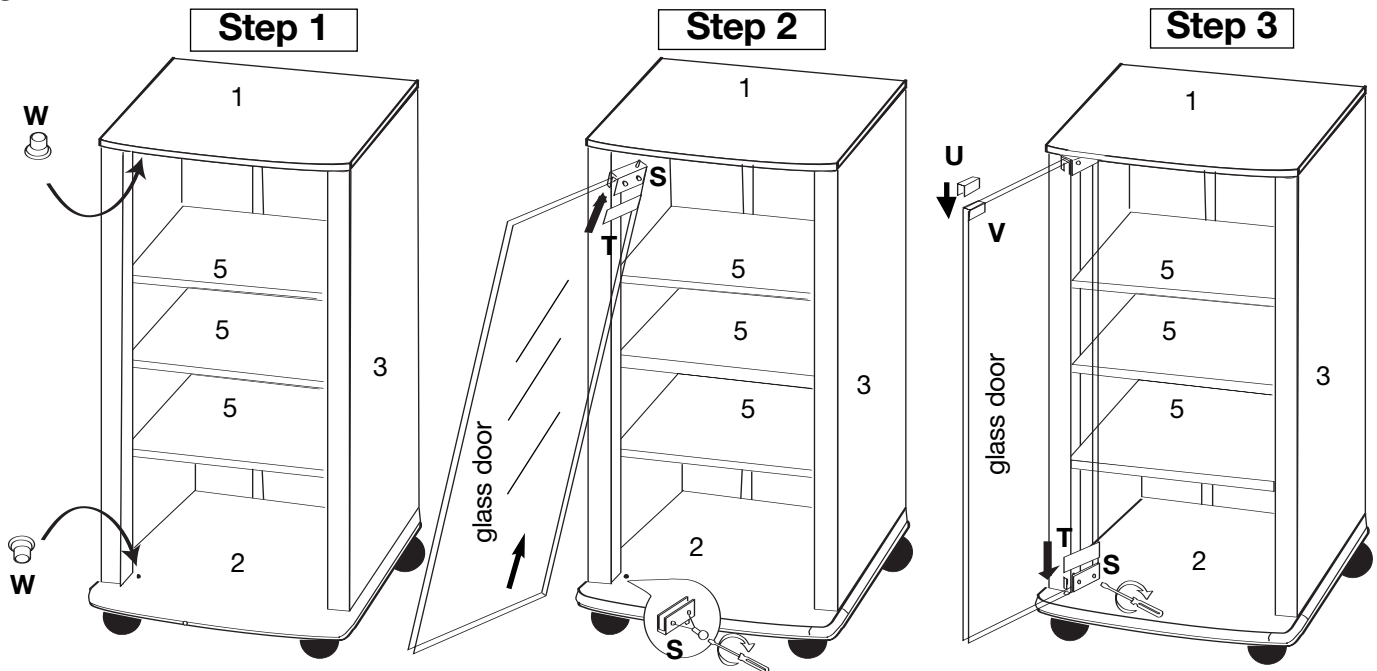
GLASS DOOR — ATTACH TOP HINGE FIRST.

Insert 1 plastic bushing (W) into hole in Bottom Panel (2) and 1 Plastic Bushing (W) into hole of underside of Top Panel (1). Fit top Hinge (S) over top corner of glass door. Slip protective plate (T) between glass and hinge setting screws. Slightly tighten screws carefully. Insert bottom Hinge (S) into bottom Bushing (W) and then slip door into hinge, after inserting top corner. Slip protective plate (T) between glass and hinge setting screws. Tighten screws carefully. NOTE: If door does not fit properly, loosen setting screws and slide door in hinge as necessary. Make sure setting screws stay in contact with protective plates when tightened. Remove paper backing from foam pad (V) and attach/wrap over top outer corner of door. Do not stretch. Slide metal strike plate (U) over pad.

IMPORTANT NOTICE

Top Panel, Part #1 is designed to be used with TV's and other A/V equipment **NOT weighing more than 80 lbs.**

The loading weight needs to be evenly distributed across top panel and for optimum stability, Place TV in a center position on Top Panel, **not unbalanced to the side against edge** for example.

Also: Note dimensions for Top Panel Surface as listed at the beginning of this manual and read the following "**Important Safety Precautions**".

Bottom Panel, Part #2 is designed to be used with A/V components **NOT weighing more than 44 lbs.**

Adjustable Shelves, Part #5, are designed to be used with A/V components **NOT weighing more than 33 lbs. per shelf.** **HOWEVER**, for the total unit loading capacity, **DO NOT exceed a total of 200 lbs.**

IMPORTANT SAFETY PRECAUTIONS

Please carefully read & follow these **important safety information notes** for proper use of the furniture you have just assembled. They are **designed to avoid unsafe conditions** that can result in property damage, bodily injury or death. We therefore urge strict adherence to the following basic principals:

- Install this unit on a flat & level surface only.
- Avoid placing unit in direct sunlight or near heating source. We recommend not placing unit directly against wall but rather leaving a narrow space between unit and wall for proper ventilation of your A/V equipment.
- Do not exceed the above recommended weight loading limits as this can result in sagging or structural failure of the supporting panel leading to unsafe conditions.
- TV screen sizes are measured diagonally, therefore, base foot-print size for specific TV's can not be determined by screen size as they vary from manufacturer to manufacturer. Rather you will need to measure the TV's base foot print and compare it to the top panel surface size of your furniture as listed in this manual.
- Make sure to place TV **within** the surface area of the top panel, a bit inward from the front edge and centered. **Never** use with a TV that is **too large**. **The TV base foot print surface must be able to sit completely on the top panel surface.**
- When choosing locations for stacking A/V components on shelves, make sure to place the heaviest A/V equipment on the lowest possible shelves/bottom panels first.
- **Children should never be allowed to climb on or play with this furniture or/and the TV.** This can result in an unsafe situation which may lead to the TV and/or the furniture itself to become unsteady, slip, tip or fall over. Avoid using higher shelves or the top surface of the TV for objects that may tempt children to reach and climb. Such items can include toys, food, as well as remote controls, etc. Proper supervision and common sense is always required.
- Glass doors are "Tempered." This is a special process for achieving strength and safety. Although durable & solid we recommend avoiding bumping into glass with force or dropping or chipping edges etc. Special caution should be given to glass corners, both, for protection of glass as well as most importantly to avoid the possibility of injuries resulting from strong impacts against corners especially with children. Doors should be opened & closed gently. (Tempered glass is designed to shatter upon very strong impact and rather than producing sharp knife-like dangerous edges, it turns instead into small pebble-like pieces.)
- **Moving the unit:** The strong caster wheels on this unit are intended for normal short-distance indoor use only, not for rough floor surfaces or outdoor use. Do not drag unit when moving and especially be careful not to move unit on a carpeted surface or on a rug if it may pose resistance for caster mobility. If conditions are such, it is always recommended instead to lift unit from both ends with a friend's help. For the sake of safety and to avoid damages, we recommend you move the TV and all A/V components prior to moving this unit. If this is not possible please use much caution and good judgement and seek help to ensure stability and safety as the unit is being moved. Make sure afterwards to properly re-adjust all equipment, centered and stable as originally instructed above.

Congratulations and enjoy your new ELITE product!

To clean your unit, apply window cleaner with soft. tissue. This will also eliminate slight surface abrasions or scratches that may have occurred in shipping or handling.

Distributed by: Elite Industries
77 Gould Street • Bayonne, NJ 07002

Elite Industries ensures complete satisfaction with this product. In the event of missing or damaged parts call toll free, **Customer service hours: 8:45-4:45, Monday-Friday, EST.**
1-800 ELITE-48 • TEL.: 201-436-1120 • FAX: 201-436-6960
VISIT OUR WEBSITE AT: www.elite-inds.com